

**Pulegge dentate per bussola conica**  
**Timing belt pulleys for taper bushes**  
**Zahnriemenscheiben für Spannbüchsen**  
**Poulies dentées à moyeu amovible**  
**Poleas dentadas para**  
**casquillos cónicos (taper)**

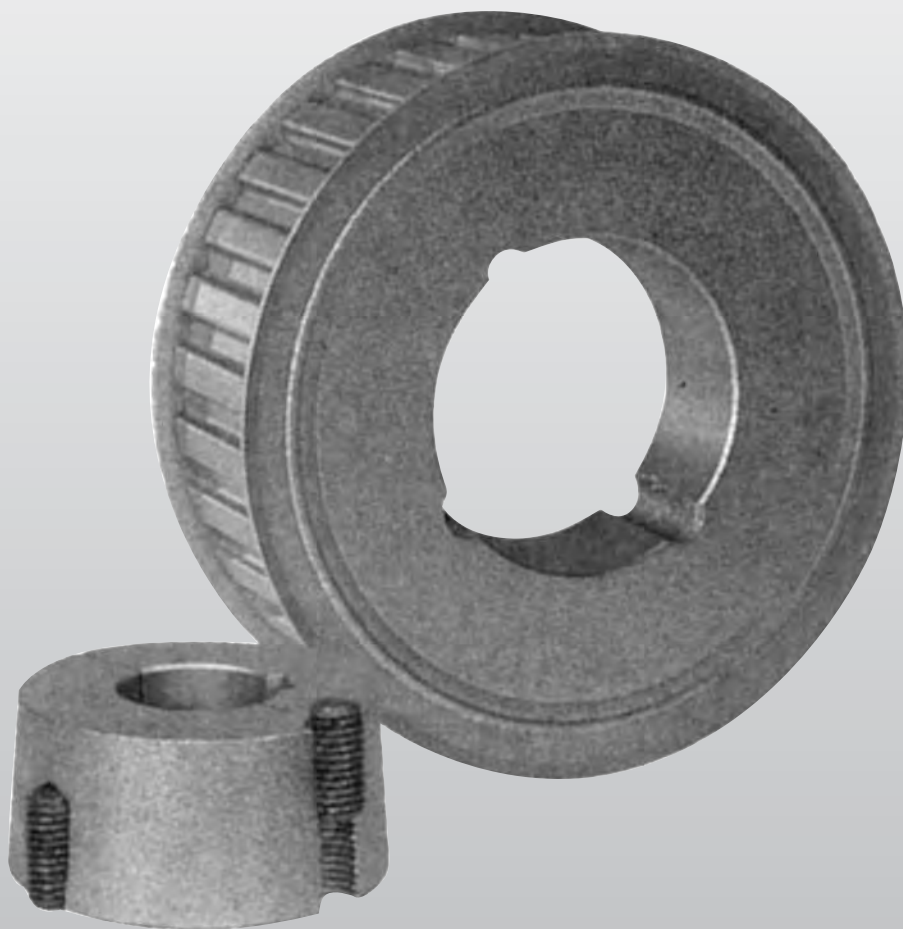

Pulgege dentate per bussola conica  
 Timing belt pulleys for taper bushes  
 Zahnriemenscheiben für Spannbüchsen  
 Poulies dentées à moyeu amovible  
 Poleas dentadas para casquillos cónicos (taper)

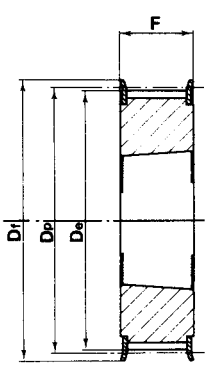

tipo  
type 3F

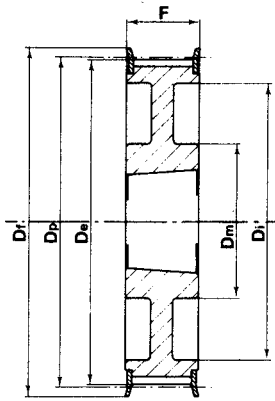

tipo  
type 3WF

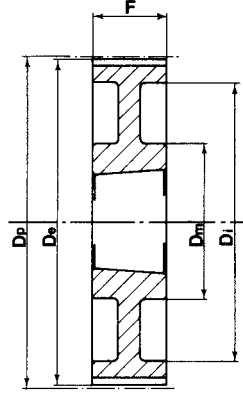

tipo  
type 3W

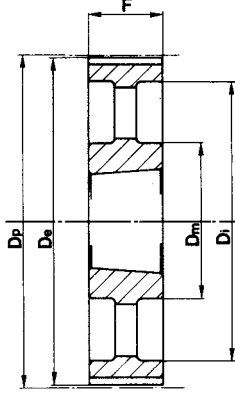

tipo  
type 3A

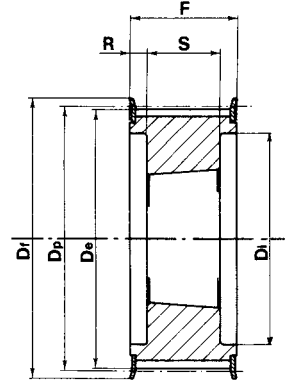

tipo  
type 4F

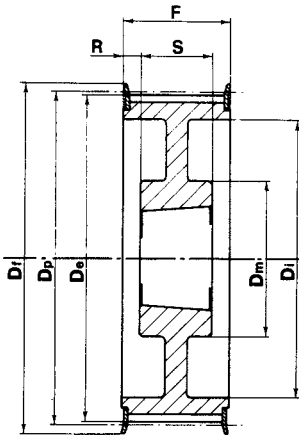

tipo  
type 4WF

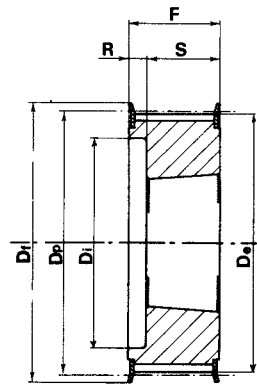

tipo  
type 5F

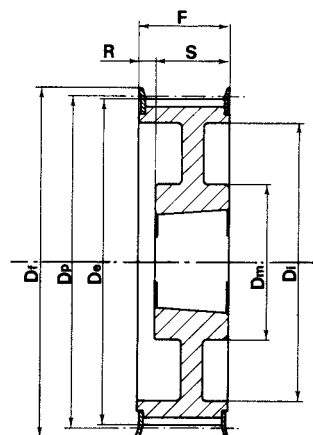

tipo  
type 5WF

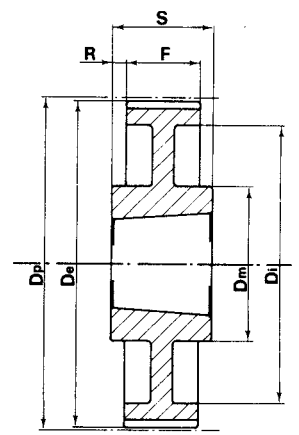

tipo  
type 7W

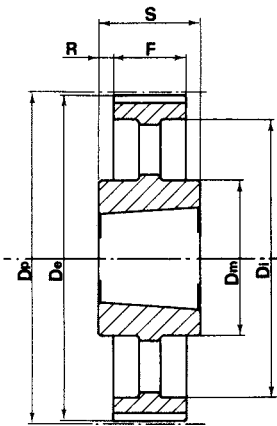

tipo  
type 7A

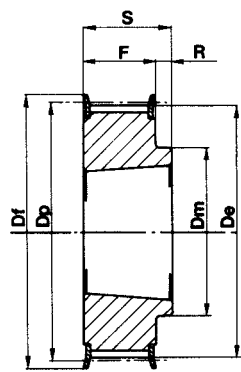

tipo  
type 8F

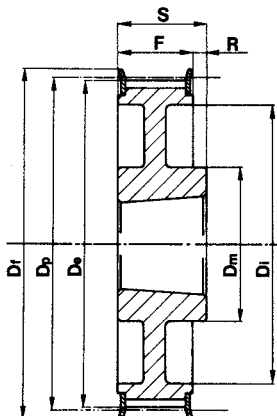

tipo  
type 8WF

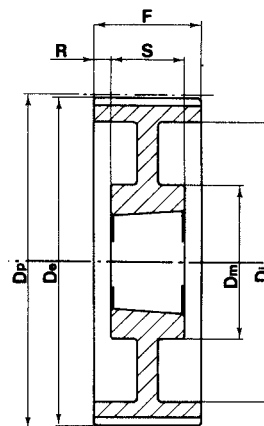

tipo  
type 9W

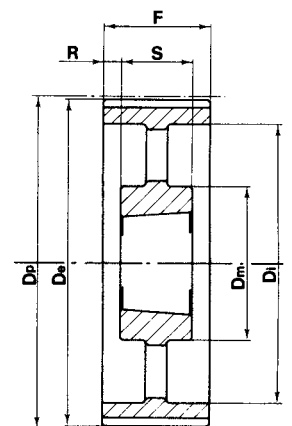

tipo  
type 9A

**Pulegge dentate per bussola conica**  
**Timing belt pulleys for taper bushes**  
**Zahnriemenscheiben für Spannbüchsen**  
**Poulies dentées à moyeu amovible**  
**Poleas dentadas para casquillos cónicos (taper)**

**L 050 - 3/8" (9,525 mm)**

CARATTERISTICHE FEATURES MERKMALE CARACTERISTIQUES CARACTERISTICAS		CODICE CODE SYMBOL FABRIK- NUMMER CODE SYMBOLE NUMERO DE FABRICA	NOSTRO CODICE OUR CODE UNSER KODE NOTRE CODE NUESTRO CODIGO	TIPO TYPE TYP TYPE TIPO	TIPO FLANGIA FLANGES TYPE BORD- SCHEIBEN TYPE FLASQUES TIPO TAPETAS	BUSSOLA BUSH BUCHSE MOYEU CASQUILLO	FORO MAX. MAX. BORE MAX. BOHRUNG ALESAGE MAX. AGUJERO MAX.	Dp	De	Df	Dm	Di	F	S	R	PESO WEIGHT GEWICHT POIDS PESO Kg
ACCIAIO STEEL STAHL ACIER ACERO	CON FLANGIA WITH FLANGES MIT FLANSCHEN AVEC FLASQUES CON TAPETAS	18 L 050	TL50018	8F	F22	1108	28	54,57	53,81	60	45	—	19,0	22,0	3	0,2
		19 L 050	TL50019	8F	F24	1108	28	57,61	56,84	64	45	—	19,0	22,0	3	0,2
		20 L 050	TL50020	8F	F25	1108	28	60,64	59,88	66	48	—	19,0	22,0	3	0,2
		21 L 050	TL50021	8F	F26	1108	28	63,67	62,91	70	48	—	19,0	22,0	3	0,3
		22 L 050	TL50022	8F	F27	1108	28	66,70	65,94	75	51	—	19,0	22,0	3	0,3
	SENZA FLANGIA WITHOUT FLANGES OHNE FLANSCHEN SANS FLASQUES SIN TAPETAS	23 L 050	TL50023	8F	F28	1108	28	69,73	68,97	79	54	—	19,0	22,0	3	0,4
		24 L 050	TL50024	8F	F28	1108	28	72,77	72,00	79	54	—	19,0	22,0	3	0,4
		25 L 050	TL50025	8F	F29	1108	28	75,80	75,04	83	56	—	19,0	22,0	3	0,5
		26 L 050	TL50026	8F	F30	1108	28	78,83	78,07	87	60	—	19,0	22,0	3	0,5
		27 L 050	TL50027	8F	F30	1108	28	81,86	81,10	87	62	—	19,0	22,0	3	0,6
		28 L 050	TL50028	8F	F31	1108	28	84,89	84,13	91	65	—	19,0	22,0	3	0,6
		30 L 050	TL50030	8F	F33	1108	28	90,96	90,20	97	70	—	19,0	22,0	3	0,8
		32 L 050	TL50032	8F	F34	1108	28	97,02	96,26	102	74	—	19,0	22,0	3	0,9
		36 L 050	TL50036	8F	F37	1108	28	109,15	108,39	115	85	—	19,0	22,0	3	1,2
		40 L 050	TL50040	8F	F40	1610	42	121,28	120,51	128	88	—	19,0	25,0	3	1,5
		44 L 050	TL50044	8WF	F45	1610	42	133,40	132,64	142	88	110	19,0	25,0	6	1,8
48 L 050	TL50048	8WF	F48	1610	42	145,53	144,77	150	88	120	19,0	25,0	6	2,3		
GHISA CAST IRON GRAUGUSS FONTE HIERRO FUNDIDO	60 L 050	TL50060	7W		1610	42	181,91	181,15	—	92	166	19,0	25,0	6	2,0	
	72 L 050	TL50072	7A		1610	42	218,30	217,53	—	92	202	19,0	25,0	6	3,0	
	84 L 050	TL50084	7A		1610	42	254,68	253,90	—	92	236	19,0	25,0	6	4,0	
	96 L 050	TL50096	7A		2012	50	291,06	290,30	—	106	270	19,0	32,0	13	5,5	
	120 L 050	TL50120	7A		2012	50	363,83	363,07	—	106	343	19,0	32,0	13	6,8	

**Pullegge dentate per bussola conica**  
**Timing belt pulleys for taper bushes**  
**Zahnriemenscheiben für Spannbüchsen**  
**Poulies dentées à moyeu amovible**  
**Poleas dentadas para casquillos cónicos (taper)**

### L 075 - 3/8" (9,525 mm)

CARATTERISTICHE FEATURES MERKMALE CARACTERISTIQUES CARACTERÍSTICAS		CODICE CODE SYMBOL FABRIKNUMMER CODE SYMBOLE NUMERO DE FABRICA	NOSTRO CODICE OUR CODE UNSER KODE NOTRE CODE NUESTRO CODIGO	TIPO TYPE TYP TYPE TIPO	TIPO FLANGIA FLANGES TYPE BORDSCHEIBEN TYP TYPE FLASQUES TIPO TAPETAS	BUSSOLA BUSH BUCHSE MOYEU CASQUILLO	FORO MAX. MAX. BORE MAX. BOHRUNG ALESAGE MAX. AGUJERO MAX.	Dp	De	Df	Dm	Di	F	S	R	PESO WEIGHT GEWICHT POIDS PESO Kg
ACCIAIO STEEL STAHL ACIER ACERO	CON FLANGIA WITH FLANGES MIT FLANSCHEN AVEC FLASQUES CON TAPETAS	18 L 075	TL75018	3F	F22	1108	28	54,57	53,81	60	—	—	25,0	25,0	—	0,2
		19 L 075	TL75019	3F	F24	1108	28	57,61	56,84	64	—	—	25,0	25,0	—	0,3
		20 L 075	TL75020	3F	F25	1108	28	60,64	59,88	66	—	—	25,0	25,0	—	0,3
		21 L 075	TL75021	3F	F26	1108	28	63,67	62,91	70	—	—	25,0	25,0	—	0,4
		22 L 075	TL75022	3F	F27	1108	28	66,70	65,94	75	—	—	25,0	25,0	—	0,4
		23 L 075	TL75023	3F	F28	1108	28	69,73	68,97	79	—	—	25,0	25,0	—	0,4
		24 L 075	TL75024	3F	F28	1108	28	72,77	72,00	79	—	—	25,0	25,0	—	0,5
		25 L 075	TL75025	3F	F29	1108	28	75,80	75,04	83	—	—	25,0	25,0	—	0,6
		26 L 075	TL75026	3F	F30	1108	28	78,83	78,07	87	—	—	25,0	25,0	—	0,6
		27 L 075	TL75027	3F	F30	1108	28	81,86	81,10	87	—	—	25,0	25,0	—	0,7
		28 L 075	TL75028	3F	F31	1108	28	84,89	84,13	91	—	—	25,0	25,0	—	0,7
		30 L 075	TL75030	3F	F33	1108	28	90,96	90,20	97	—	—	25,0	25,0	—	0,9
		32 L 075	TL75032	3F	F34	1108	28	97,02	96,26	102	—	—	25,0	25,0	—	1,0
		36 L 075	TL75036	3F	F37	1610	42	109,15	108,39	115	—	—	25,0	25,0	—	1,2
		40 L 075	TL75040	3F	F40	1610	42	121,28	120,51	128	—	—	25,0	25,0	—	1,7
		44 L 075	TL75044	3WF	F45	1610	42	133,40	132,64	142	90	110	25,0	25,0	—	2,1
		48 L 075	TL75048	3WF	F48	1610	42	145,53	144,77	150	92	120	25,0	25,0	—	2,5
		GHISA CAST IRON GRAUGUSS FONTE HIERRO FUNDIDO	SENZA FLANGIA WITHOUT FLANGES OHNE FLANSCHEN SANS FLASQUES SIN TAPETAS	60 L 075	TL75060	3W		1610	42	181,91	181,15	—	92	166	25,0	25,0
72 L 075	TL75072			3A		1610	42	218,30	217,53	—	92	202	25,0	25,0	—	4,0
84 L 075	TL75084			7A		2012	50	254,68	253,90	—	92	236	25,0	32,0	—	5,2
96 L 075	TL75096			7A		2012	50	291,06	290,30	—	106	270	25,0	32,0	3,5	6,5
120 L 075	TL75120			7A		2012	50	363,83	363,07	—	106	343	25,0	32,0	3,5	7,6

### L 100 - 3/8" (9,525 mm)

CARATTERISTICHE FEATURES MERKMALE CARACTERISTIQUES CARACTERÍSTICAS		CODICE CODE SYMBOL FABRIKNUMMER CODE SYMBOLE NUMERO DE FABRICA	NOSTRO CODICE OUR CODE UNSER KODE NOTRE CODE NUESTRO CODIGO	TIPO TYPE TYP TYPE TIPO	TIPO FLANGIA FLANGES TYPE BORDSCHEIBEN TYP TYPE FLASQUES TIPO TAPETAS	BUSSOLA BUSH BUCHSE MOYEU CASQUILLO	FORO MAX. MAX. BORE MAX. BOHRUNG ALESAGE MAX. AGUJERO MAX.	Dp	De	Df	Dm	Di	F	S	R	PESO WEIGHT GEWICHT POIDS PESO Kg
ACCIAIO STEEL STAHL ACIER ACERO	CON FLANGIA WITH FLANGES MIT FLANSCHEN AVEC FLASQUES CON TAPETAS	18 L 100	TL10018	5F	F22	1108	28	54,57	53,81	60	—	38	31,0	22,0	9,0	0,2
		19 L 100	TL10019	5F	F24	1108	28	57,61	56,84	64	—	38	31,0	22,0	9,0	0,3
		20 L 100	TL10020	5F	F25	1108	28	60,64	59,88	66	—	45	31,0	22,0	9,0	0,4
		21 L 100	TL10021	5F	F26	1108	28	63,67	62,91	70	—	45	31,0	22,0	9,0	0,4
		22 L 100	TL10022	5F	F27	1108	28	66,70	65,94	75	—	48	31,0	22,0	9,0	0,4
		23 L 100	TL10023	5F	F28	1108	28	69,73	68,97	79	—	52	32,0	22,0	10,0	0,5
		24 L 100	TL10024	5F	F28	1108	28	72,77	72,00	79	—	52	32,0	22,0	10,0	0,6
		25 L 100	TL10025	5F	F29	1108	28	75,80	75,04	83	—	54	32,0	22,0	10,0	0,6
		26 L 100	TL10026	5F	F30	1108	28	78,83	78,07	87	—	60	32,0	22,0	10,0	0,7
		27 L 100	TL10027	5F	F30	1108	28	81,86	81,10	91	—	60	32,0	22,0	10,0	0,8
		28 L 100	TL10028	5F	F31	1108	28	84,89	84,13	91	—	65	32,0	22,0	10,0	0,8
		30 L 100	TL10030	5F	F33	1210	32	90,96	90,20	97	—	71	32,0	25,0	7,0	0,9
		32 L 100	TL10032	5F	F34	1210	32	97,02	96,26	102	—	75	32,0	25,0	7,0	1,0
		36 L 100	TL10036	5F	F37	1610	42	109,15	108,39	115	—	86	32,0	25,0	7,0	1,4
		40 L 100	TL10040	5F	F40	1610	42	121,28	120,51	128	—	96	32,0	25,0	7,0	1,7
		44 L 100	TL10044	5WF	F45	1610	42	133,40	132,64	142	90	110	32,0	25,0	—	2,3
		48 L 100	TL10048	5WF	F48	1610	42	145,53	144,77	150	92	120	32,0	25,0	7,0	2,7
		GHISA CAST IRON GRAUGUSS FONTE HIERRO FUNDIDO	SENZA FLANGIA WITHOUT FLANGES OHNE FLANSCHEN SANS FLASQUES SIN TAPETAS	60 L 100	TL10060	9W		1610	42	181,91	181,15	—	92	166	32,0	25,0
72 L 100	TL10072			3A		2012	50	218,30	217,53	—	92	202	32,0	32,0	—	4,4
84 L 100	TL10084			3A		2012	50	254,68	253,90	—	92	236	32,0	32,0	—	6,0
96 L 100	TL10096			3A		2012	50	291,06	290,30	—	106	270	32,0	32,0	—	7,1
120 L 100	TL10120			3A		2012	50	363,83	363,07	—	106	343	32,0	32,0	—	8,5

**Pulgege dentate per bussola conica**  
**Timing belt pulleys for taper bushes**  
**Zahnriemenscheiben für Spannbüchsen**  
**Poulies dentées à moyeu amovible**  
**Poleas dentadas para casquillos cónicos (taper)**



**H 100 - 1/2" (12,7 mm)**

CARATTERISTICHE FEATURES MERKMALE CARACTERISTIQUES CARACTERÍSTICAS		CODICE CODE SYMBOL FABRIKNUMMER CODE SYMBOLE NUMERO DE FABRICA	NOSTRO CODICE OUR CODE UNSER KODE NOTRE CODE NUESTRO CODIGO	TIPO TYPE TYP TYPE TIPO	TIPO FLANGIA FLANGES TYPE BORDSCHEIBEN TYP TYPE FLASQUES TIPO TAPETAS	BUSSOLA BUSH BUCHSE MOYEU CASQUILLO	FORO MAX. MAX. BORE MAX. BOHRUNG ALESAGE MAX. AGUJERO MAX.	Dp	De	Df	Dm	Di	F	S	R	PESO WEIGHT GEWICHT POIDS PESO Kg
ACCIAIO STEEL STAHL ACIER ACERO	CON FLANGIA WITH FLANGES MIT FLANSCHEN AVEC FLASQUES CON TAPETAS	16 H100	TH 10016	5F	F26	1108	28	64,68	63,31	70	—	45	31,0	22,0	9,0	0,4
		18 H100	TH 10018	5F	F28	1210	32	72,77	71,39	79	—	52	31,0	25,0	6,0	0,5
		19 H100	TH 10019	5F	F29	1210	32	76,81	75,44	83	—	56	31,0	25,0	6,0	0,6
		20 H100	TH 10020	5F	F30	1210	32	80,55	79,48	87	—	60	31,0	25,0	6,0	0,7
		21 H100	TH 10021	5F	F31	1210	32	84,89	83,52	91	—	64	32,0	25,0	7,0	0,8
		22 H100	TH 10022	5F	F32	1210	32	88,94	87,56	93	—	67	32,0	25,0	7,0	0,9
		23 H100	TH 10023	5F	F33	1610	42	92,98	91,61	97	—	70	32,0	25,0	7,0	0,9
		24 H100	TH 10024	5F	F34	1610	42	97,02	95,65	102	—	74	32,0	25,0	7,0	1,0
		25 H100	TH 10025	5F	F35	1610	42	101,06	99,69	106	—	77	32,0	25,0	7,0	1,0
		26 H100	TH 10026	5F	F36	1610	42	105,11	103,73	112	—	82	32,0	25,0	7,0	1,2
		27 H100	TH 10027	5F	F37	1610	42	109,15	107,78	115	—	85	32,0	25,0	7,0	1,3
		28 H100	TH 10028	5F	F38	1610	42	113,19	111,82	120	—	90	32,0	25,0	7,0	1,5
		30 H100	TH 10030	5F	F40	1610	42	121,28	119,90	128	—	98	32,0	25,0	7,0	1,7
		32 H100	TH 10032	5WF	F42	1610	42	129,36	127,99	135	80	106	32,0	25,0	7,0	2,0
		36 H100	TH 10036	5WF	F48	1610	42	145,53	144,16	150	92	121	32,0	25,0	7,0	2,7
40 H100	TH 10040	5WF	F52	1610	42	161,70	160,33	168	92	138	32,0	25,0	7,0	3,6		
44 H100	TH 10044	3WF	F55	2012	50	177,87	176,50	184	106	152	32,0	32,0	—	3,8		
48 H100	TH 10048	3WF	F59	2012	50	194,04	192,67	200	106	169	32,0	32,0	—	3,2		
GHISA CAST IRON GRAUGUSS FONTE HIERRO FUNDIDO	SENZA FLANGIA WITHOUT FLANGES OHNE FLANSCHEN SANS FLASQUES SIN TAPETAS	60 H100	TH 10060	9A		2012	50	242,55	241,18	—	92	223	34,0	32,0	1,0	4,8
		72 H100	TH 10072	9A		2012	50	291,06	289,69	—	92	270	34,0	32,0	1,0	5,7
		84 H100	TH 10084	9A		2012	50	339,57	338,20	—	92	318	34,0	32,0	1,0	6,8
		96 H100	TH 10096	7A		2517	60	388,08	386,71	—	106	366	34,0	45,0	5,5	8,2
		120 H100	TH 10120	7A		2517	60	485,10	483,73	—	106	462	34,0	45,0	5,5	12,1

**H 150 - 1/2" (12,7 mm)**

CARATTERISTICHE FEATURES MERKMALE CARACTERISTIQUES CARACTERÍSTICAS		CODICE CODE SYMBOL FABRIKNUMMER CODE SYMBOLE NUMERO DE FABRICA	NOSTRO CODICE OUR CODE UNSER KODE NOTRE CODE NUESTRO CODIGO	TIPO TYPE TYP TYPE TIPO	TIPO FLANGIA FLANGES TYPE BORDSCHEIBEN TYP TYPE FLASQUES TIPO TAPETAS	BUSSOLA BUSH BUCHSE MOYEU CASQUILLO	FORO MAX. MAX. BORE MAX. BOHRUNG ALESAGE MAX. AGUJERO MAX.	Dp	De	Df	Dm	Di	F	S	R	PESO WEIGHT GEWICHT POIDS PESO Kg
ACCIAIO STEEL STAHL ACIER ACERO	CON FLANGIA WITH FLANGES MIT FLANSCHEN AVEC FLASQUES CON TAPETAS	18 H150	TH 15018	5F	F28	1210	32	72,77	71,39	79	—	52	45,0	25,0	20,0	0,6
		19 H150	TH 15019	5F	F29	1210	32	76,81	75,44	83	—	56	45,0	25,0	20,0	0,7
		20 H150	TH 15020	5F	F30	1210	32	80,55	79,48	87	—	60	45,0	25,0	20,0	0,8
		21 H150	TH 15021	5F	F31	1210	32	84,89	83,52	91	—	64	45,0	25,0	20,0	1,0
		22 H150	TH 15022	5F	F32	1210	32	88,94	87,56	93	—	67	45,0	25,0	20,0	1,2
		23 H150	TH 15023	5F	F33	1610	42	92,98	91,61	97	—	70	45,0	25,0	20,0	1,3
		24 H150	TH 15024	5F	F34	1610	42	97,02	95,65	102	—	74	45,0	25,0	20,0	1,0
		25 H150	TH 15025	5F	F35	1610	42	101,06	99,69	106	—	77	45,0	25,0	20,0	1,2
		26 H150	TH 15026	5F	F36	1610	42	105,11	103,73	112	—	82	45,0	25,0	20,0	1,4
		27 H150	TH 15027	5F	F37	1610	42	109,15	107,78	115	—	85	45,0	25,0	20,0	1,6
		28 H150	TH 15028	5F	F38	1610	42	113,19	111,82	120	—	90	45,0	25,0	20,0	1,8
		30 H150	TH 15030	5F	F40	1610	42	121,28	119,90	128	—	98	45,0	25,0	20,0	2,3
		32 H150	TH 15032	5WF	F42	1610	42	129,36	127,99	135	80	106	45,0	25,0	20,0	2,3
		36 H150	TH 15036	5WF	F48	1610	42	145,53	144,16	150	92	121	45,0	25,0	20,0	3,1
		40 H150	TH 15040	5WF	F52	1610	42	161,70	160,33	168	92	138	45,0	25,0	20,0	4,0
44 H150	TH 15044	5WF	F55	2012	50	177,87	176,50	184	106	152	45,0	32,0	13,0	4,4		
48 H150	TH 15048	5WF	F59	2012	50	194,04	192,67	200	106	169	45,0	32,0	13,0	4,8		
GHISA CAST IRON GRAUGUSS FONTE HIERRO FUNDIDO	SENZA FLANGIA WITHOUT FLANGES OHNE FLANSCHEN SANS FLASQUES SIN TAPETAS	60 H150	TH 15060	9A		2012	50	242,55	241,18	—	92	223	46,0	32,0	7,5	5,4
		72 H150	TH 15072	9A		2012	50	291,06	289,69	—	92	270	46,0	32,0	7,5	6,5
		84 H150	TH 15084	9A		2012	50	339,57	338,20	—	92	318	46,0	32,0	7,5	8,4
		96 H150	TH 15096	9A		2517	60	388,08	386,71	—	106	366	46,0	45,0	0,5	11,0
		120 H150	3E 73120	9A		2517	60	485,10	483,73	—	106	462	46,0	45,0	0,5	14,8

**Pulegge dentate per bussola conica**  
**Timing belt pulleys for taper bushes**  
**Zahnriemenscheiben für Spannbüchsen**  
**Poulies dentées à moyeu amovible**  
**Poleas dentadas para casquillos cónicos (taper)**

## H 200 - 1/2" (12,7 mm)

CARATTERISTICHE FEATURES MERKMALE CARACTERÍSTICAS		CODICE CODE SYMBOL FABRIKNUMMER CODE SYMBOLE NUMERO DE FABRICA	NOSTRO CODICE OUR CODE UNSER KODE NOTRE CODE NUESTRO CODIGO	TIPO TYPE TYP TYPE TIPO	TIPO FLANGIA FLANGES TYPE BORDSCHEIBEN TYP TYPE FLASQUES TIPO TAPETAS	BUSSOLA BUSH BUCHSE MOYEU CASQUILLO	FORO MAX. MAX. BORE MAX. BOHRUNG ALESAGE MAX. AGUJERO MAX.	Dp	De	Df	Dm	Di	F	S	R	PESO WEIGHT GEWICHT POIDS PESO Kg
ACCIAIO STEEL STAHL ACIER ACERO	CON FLANGIA WITH FLANGES MIT FLANSCHEN AVEC FLASQUES CON TAPETAS	18 H 200	TH 20018	5F	F28	1210	32	72,77	71,39	79	—	52	58,0	25,0	33,0	0,8
		19 H 200	TH 20019	5F	F29	1210	32	76,81	75,44	83	—	56	58,0	25,0	33,0	0,9
		20 H 200	TH 20020	5F	F30	1610	42	80,55	79,48	87	—	60	58,0	25,0	33,0	1,0
		21 H 200	TH 20021	5F	F31	1610	42	84,89	83,52	91	—	64	58,0	25,0	33,0	1,7
		22 H 200	TH 20022	5F	F32	1610	42	88,94	87,56	93	—	67	58,0	25,0	33,0	1,5
		23 H 200	TH 20023	5F	F33	1610	42	92,98	91,61	97	—	70	58,0	25,0	33,0	1,8
		24 H 200	TH 20024	5F	F34	1610	42	97,02	95,65	102	—	74	58,0	25,0	33,0	1,5
		25 H 200	TH 20025	5F	F35	1610	42	101,06	99,69	106	—	77	58,0	25,0	33,0	1,5
		26 H 200	TH 20026	5F	F36	1610	42	105,11	103,73	112	—	82	58,0	25,0	33,0	1,8
		27 H 200	TH 20027	5F	F37	1610	42	109,15	107,78	115	—	85	58,0	25,0	33,0	1,9
		28 H 200	TH 20028	5F	F38	1610	42	113,19	111,82	120	—	90	58,0	25,0	33,0	1,9
		30 H 200	TH 20030	5F	F40	1610	42	121,28	119,90	128	—	98	58,0	25,0	33,0	2,3
		32 H 200	TH 20032	5F	F42	2012	50	129,36	127,99	135	—	106	58,0	32,0	26,0	3,0
		36 H 200	TH 20036	5WF	F48	2012	50	145,53	144,16	150	102	121	58,0	32,0	26,0	3,0
40 H 200	TH 20040	5WF	F52	2012	50	161,70	160,33	168	106	140	58,0	32,0	26,0	3,6		
44 H 200	TH 20044	5WF	F55	2012	50	177,87	176,50	184	106	150	58,0	32,0	26,0	4,0		
48 H 200	TH 20048	5WF	F59	2517	60	194,04	192,67	200	119	168	58,0	45,0	13,0	4,6		
GHISA CAST IRON GRAUGUSS FONTE HIERRO FUNDIDO	SENZA FLANGIA WITHOUT FLANGES OHNE FLANSCHEN SANS FLASQUES SIN TAPETAS	60 H 200	TH 20060	9A		2517	60	242,55	241,18	—	119	223	60,0	45,0	7,5	7,0
		72 H 200	TH 20072	9A		2517	60	291,06	289,69	—	119	270	60,0	45,0	7,5	8,0
		84 H 200	TH 20084	9A		2517	60	339,57	338,20	—	119	318	60,0	45,0	7,5	9,0
		96 H 200	TH 20096	9A		2517	60	388,08	386,71	—	119	366	60,0	45,0	7,5	10,0
		120 H 200	TH 20120	9A		2517	60	485,10	483,73	—	119	462	60,0	45,0	7,5	13,4

## H 300 - 1/2" (12,7 mm)

CARATTERISTICHE FEATURES MERKMALE CARACTERÍSTICAS		CODICE CODE SYMBOL FABRIKNUMMER CODE SYMBOLE NUMERO DE FABRICA	NOSTRO CODICE OUR CODE UNSER KODE NOTRE CODE NUESTRO CODIGO	TIPO TYPE TYP TYPE TIPO	TIPO FLANGIA FLANGES TYPE BORDSCHEIBEN TYP TYPE FLASQUES TIPO TAPETAS	BUSSOLA BUSH BUCHSE MOYEU CASQUILLO	FORO MAX. MAX. BORE MAX. BOHRUNG ALESAGE MAX. AGUJERO MAX.	Dp	De	Df	Dm	Di	F	S	R	PESO WEIGHT GEWICHT POIDS PESO Kg
ACCIAIO STEEL STAHL ACIER ACERO	CON FLANGIA WITH FLANGES MIT FLANSCHEN AVEC FLASQUES CON TAPETAS	20 H 300	TH 30020	4F	F31	1615	42	80,85	79,48	87	—	65	84,0	38,0	23,0	1,5
		21 H 300	TH 30021	4F	F31	1615	42	84,89	83,52	91	—	65	84,0	38,0	23,0	1,2
		22 H 300	TH 30022	4F	F32	1615	42	88,94	87,56	93	—	67	84,0	38,0	23,0	1,6
		23 H 300	TH 30023	4F	F33	1615	42	92,98	91,61	97	—	70	84,0	38,0	23,0	1,8
		24 H 300	TH 30024	4F	F34	1615	42	97,02	95,65	102	—	74	84,0	38,0	23,0	2,0
		25 H 300	TH 30025	4F	F35	1615	42	101,06	99,69	106	—	77	84,0	38,0	23,0	2,0
		26 H 300	TH 30026	4F	F36	1615	42	105,11	103,73	112	—	82	84,0	38,0	23,0	2,7
		27 H 300	TH 30027	4F	F37	2012	50	109,15	107,78	115	—	85	84,0	32,0	26,0	3,0
		28 H 300	TH 30028	4F	F38	2012	50	113,19	111,82	120	—	90	84,0	32,0	26,0	2,4
		30 H 300	TH 30030	4F	F40	2012	50	121,28	119,90	128	—	98	84,0	32,0	26,0	2,9
		32 H 300	TH 30032	4F	F42	2517	60	129,36	127,99	135	—	106	84,0	45,0	19,5	3,3
		36 H 300	TH 30036	4F	F48	2517	60	145,53	144,16	150	—	121	84,0	45,0	19,5	4,5
		40 H 300	TH 30040	4F	F52	2517	60	161,70	160,33	168	—	138	84,0	45,0	19,5	6,0
		44 H 300	TH 30044	4WF	F55	2517	60	177,87	176,50	184	119	150	86,0	45,0	20,5	6,6
48 H 300	TH 30048	4WF	F59	2517	60	194,04	192,67	200	119	168	86,0	45,0	20,5	7,6		
GHISA CAST IRON GRAUGUSS FONTE HIERRO FUNDIDO	SENZA FLANGIA WITHOUT FLANGES OHNE FLANSCHEN SANS FLASQUES SIN TAPETAS	60 H 300	TH 30060	9A		2517	60	242,55	241,18	—	119	223	86,0	45,0	20,5	8,4
		72 H 300	TH 30072	9A		2517	60	291,06	289,69	—	119	270	86,0	45,0	20,5	10,4
		84 H 300	TH 30084	9A		2517	60	339,57	338,20	—	119	318	86,0	45,0	20,5	12,5
		96 H 300	TH 30096	9A		3030	75	388,08	386,71	—	150	366	86,0	76,0	5,0	14,2
		120 H 300	TH 30120	9A		3030	75	485,10	483,73	—	150	462	86,0	76,0	5,0	18,8

**Pulegge dentate per bussola conica**  
**Timing belt pulleys for taper bushes**  
**Zahnriemenscheiben für Spannbüchsen**  
**Poulies dentées à moyeu amovible**  
**Poleas dentadas para casquillos cónicos (taper)**

**XH 200 - 7/8" (22,225 mm)**

CARATTERISTICHE FEATURES MERKMALE CARACTERISTIQUES CARACTERÍSTICAS		CODICE CODE SYMBOL FABRIKNUMMER CODE SYMBOLE NUMERO DE FABRICA	NOSTRO CODICE OUR CODE UNSER KODE NOTRE CODE NUESTRO CODIGO	TIPO TYPE TYP TYPE TIPO	TIPO FLANGIA FLANGES TYPE BORDSCHEIBEN TYP TYPE FLASQUES TIPO TAPETAS	BUSSOLA BUSH BUCHSE MOYEU CASQUILLO	FORO MAX. MAX. BORE MAX. BOHRUNG ALESAGE MAX. AGUJERO MAX.	Dp	De	Df	Dm	Di	F	S	R	PESO WEIGHT GEWICHT POIDS PESO Kg
GHISA CAST IRON GRAUGUSS FONTE HIERRO FUNDIDO	CON FLANGIA WITH FLANGES MIT FLANSCHEN AVEC FLASQUES CON TAPETAS	18 XH 200	TXH2018	5F	F44	2517	60	127,34	124,55	140	-	95	64	45	19	
		20 XH 200	TXH2020	5F	F49	2517	60	141,49	138,69	154	-	110	64	45	19	
		22 XH 200	TXH2022	5F	F52	2517	60	155,64	152,84	168	-	120	64	45	19	
		24 XH 200	TXH2024	5F	F55	2517	60	169,79	166,99	184	-	135	64	45	19	
		26 XH 200	TXH2026	5F	F59	2517	60	183,94	181,14	200	-	150	64	45	19	
		28 XH 200	TXH2028	4WF	F61	2517	60	198,08	195,29	212	120	165	64	45	9,5	
		30 XH 200	TXH2030	4WF	F62	2517	60	212,23	209,44	226	120	180	64	45	9,5	
		32 XH 200	TXH2032	4WF	F64	2517	60	226,38	223,59	240	120	195	64	45	9,5	
		40 XH 200	TXH2040	4WF	F70	3020	75	282,98	280,18	296	160	245	64	51	9,5	
	SENZA FLANGIA WITHOUT FLANGES OHNE FLANSCHEN SANS FLASQUES SIN TAPETAS	48 XH 200	TXH2048	9W		3020	75	339,57	336,78	-	160	300	64	51	6,5	
		60 XH 200	TXH2060	7A		3535	90	424,47	421,67	-	190	385	64	89	12,5	
		72 XH 200	TXH2072	7A		3535	90	509,40	506,56	-	190	470	64	89	12,5	
		84 XH 200	TXH2084	7A		3535	90	594,25	591,46	-	190	555	64	89	12,5	
		96 XH 200	TXH2096	7A		3535	90	679,15	676,35	-	190	640	64	89	12,5	
		120 XH 200	TXH2120	7A		3535	90	848,93	846,14	-	190	810	64	89	12,5	

**XH 300 - 7/8" (22,225 mm)**

CARATTERISTICHE FEATURES MERKMALE CARACTERISTIQUES CARACTERÍSTICAS		CODICE CODE SYMBOL FABRIKNUMMER CODE SYMBOLE NUMERO DE FABRICA	NOSTRO CODICE OUR CODE UNSER KODE NOTRE CODE NUESTRO CODIGO	TIPO TYPE TYP TYPE TIPO	TIPO FLANGIA FLANGES TYPE BORDSCHEIBEN TYP TYPE FLASQUES TIPO TAPETAS	BUSSOLA BUSH BUCHSE MOYEU CASQUILLO	FORO MAX. MAX. BORE MAX. BOHRUNG ALESAGE MAX. AGUJERO MAX.	Dp	De	Df	Dm	Di	F	S	R	PESO WEIGHT GEWICHT POIDS PESO Kg
GHISA CAST IRON GRAUGUSS FONTE HIERRO FUNDIDO	CON FLANGIA WITH FLANGES MIT FLANSCHEN AVEC FLASQUES CON TAPETAS	18 XH 300	TXH3018	5F	F44	2517	60	127,34	124,55	140	-	95	90	45	45	
		20 XH 300	TXH3020	5F	F49	2517	60	141,49	138,69	154	-	110	90	45	45	
		22 XH 300	TXH3022	5F	F52	2517	60	155,64	152,84	168	-	120	90	45	45	
		24 XH 300	TXH3024	5F	F55	2517	60	169,79	166,99	184	-	135	90	45	45	
		26 XH 300	TXH3026	5F	F59	2517	60	183,94	181,14	200	-	150	90	45	45	
		28 XH 300	TXH3028	5F	F61	3020	75	198,08	195,29	212	120	165	90	51	39	
		30 XH 300	TXH3030	5F	F62	3020	75	212,23	209,44	226	120	180	90	51	39	
		32 XH 300	TXH3032	5F	F64	3020	75	226,38	223,59	240	120	195	90	51	39	
		40 XH 300	TXH3040	4WF	F70	3020	75	282,98	280,18	296	160	245	90	51	19,5	
	SENZA FLANGIA WITHOUT FLANGES OHNE FLANSCHEN SANS FLASQUES SIN TAPETAS	48 XH 300	TXH3048	9A		3020	75	339,57	336,78	-	160	300	90	51	19,5	
		60 XH 300	TXH3060	9A		3535	90	424,47	421,67	-	190	385	90	89	0,5	
		72 XH 300	TXH3072	9A		3535	90	509,40	506,56	-	190	470	90	89	0,5	
		84 XH 300	TXH3084	7A		4040	100	594,25	591,46	-	190	555	90	102	6	
		96 XH 300	TXH3096	7A		4040	100	679,15	676,35	-	190	640	90	102	6	
		120 XH 300	TXH3120	7A		4040	100	848,93	846,14	-	190	810	90	102	6	

**Pulegge dentate per bussola conica**  
**Timing belt pulleys for taper bushes**  
**Zahnriemenscheiben für Spannbüchsen**  
**Poulies dentées à moyeu amovible**  
**Poleas dentadas para casquillos cónicos (taper)**

**XH 400 - 7/8" (22,225 mm)**

CARATTERISTICHE FEATURES MERKMALE CARACTERISTIQUES CARACTERÍSTICAS		CODICE CODE SYMBOL FABRIKNUMMER CODE SYMBOLE NUMERO DE FABRICA	NOSTRO CODICE OUR CODE UNSER KODE NOTRE CODE NUESTRO CODIGO	TIPO TYPE TYP TYPE TIPO	TIPO FLANGIA FLANGES TYPE BORDSCHEIBEN TYP TYPE FLASQUES TIPO TAPETAS	BUSSOLA BUSH BUCHSE MOYEU CASQUILLO	FORO MAX. MAX. BORE MAX. BOHRUNG ALESAGE MAX. AGUJERO MAX.	Dp	De	Df	Dm	Di	F	S	R	PESO WEIGHT GEWICHT POIDS PESO Kg
GHISA CAST IRON GRAUGUSS FONTE HIERRO FUNDIDO	CON FLANGIA WITH FLANGES MIT FLANSCHEN AVEC FLASQUES CON TAPETAS	<b>18 XH 400</b>	<b>TXH4018</b>	5F	F44	2517	60	127,34	124,55	140	-	95	119	45	74	
		<b>20 XH 400</b>	<b>TXH4020</b>	5F	F49	2517	60	141,49	138,69	154	-	110	119	45	74	
		<b>22 XH 400</b>	<b>TXH4022</b>	5F	F52	2517	60	155,64	152,84	168	-	120	119	45	74	
		<b>24 XH 400</b>	<b>TXH4024</b>	5F	F55	3020	75	169,79	166,99	184	-	135	119	51	68	
		<b>26 XH 400</b>	<b>TXH4026</b>	5F	F59	3020	75	183,94	181,14	200	-	150	119	51	68	
		<b>28 XH 400</b>	<b>TXH4028</b>	5F	F61	3020	75	198,08	195,29	212	120	165	119	51	68	
		<b>30 XH 400</b>	<b>TXH4030</b>	5F	F62	3020	75	212,23	209,44	226	120	180	119	51	68	
		<b>32 XH 400</b>	<b>TXH4032</b>	5F	F64	3020	75	226,38	223,59	240	120	195	119	51	68	
		<b>40 XH 400</b>	<b>TXH4040</b>	4WF	F70	3535	90	282,98	280,18	296	160	245	119	89	15	
	SENZA FLANGIA WITHOUT FLANGES OHNE FLANSCHEN SANS FLASQUES SIN TAPETAS	<b>48 XH 400</b>	<b>TXH4048</b>	9W		3535	90	339,57	336,78	-	160	300	119	89	15	
		<b>60 XH 400</b>	<b>TXH4060</b>	9A		4040	100	424,47	421,67	-	190	385	119	102	8,5	
		<b>72 XH 400</b>	<b>TXH4072</b>	9A		4040	100	509,40	506,56	-	190	470	119	102	8,5	
		<b>84 XH 400</b>	<b>TXH4084</b>	9A		4040	100	594,25	591,46	-	190	555	119	102	8,5	
		<b>96 XH 400</b>	<b>TXH4096</b>	9A		4040	100	679,15	676,35	-	190	640	119	102	8,5	
		<b>120 XH 4000</b>	<b>TXH4120</b>	9A		4040	100	848,93	846,14	-	190	810	119	102	8,5	